

# Marathon Homes Corp.

PINE CREEK INDUSTRIAL PARK • P.O. BOX 1302 • ELKHART, IN 46515

☎ (800) 803-0117 ☎ (574) 294-6441 ☎ FAX (574) 522-5923

[WWW.MARATHONHOMES.COM](http://WWW.MARATHONHOMES.COM)



*“For the Long Run”*



*Custom Designed To  
Meet YOUR Needs.*



## Construction

- 96" Ext. Width/8' Int. Height
- Fiberglass Caps w/Radius Roof Edges
- Gel-Coat Fiberglass Siding
- All Weather Rubber Roofing w/ 3/8" Plating
- Tri-Axles on 37' and Up
- Elec. Jacks – Frt. Landing Gear
- Stabilizer Jacks
- Electric Slide-Out System-flush Floor
- 5/8" T & G Plywood Floor Decking
- 2" x 4" floor Joists
- Spare Tire, Under Carriage Carrier
- Shock Absorbers
- Enclosed Heated Tanks

## Accommodations

- Residential Style Vinyl Flooring
- Oak Hardwood Cabinet Fronts & Door
- Res. Dbl. Bowl Sink w/Single Lever Pull-Out Faucet
- Corian Countertop
- Residential Style Drawer Guides
- Silverware Drawer w/Cutting Board
- Day/Night Pleated Shades
- Fiberglass Tub/Shower w/Surround
- Shower Door
- Dining Room Table w/4 chairs
- Large Lavatory Sink - Porcelain
- Wall Hugger Recliner w/Foot Rest
- Hide-A-Bed Sofa
- Roll-Up Awning
- Cedar Floor in Wardrobes
- Double-Powered Vent in Bath
- Skylight over Tub or Shower

## Appliances/Electrical

- 3-Burner Designer Range w/21" Oven, High Output Burner (9,000 BTU) Sealed Burners
- Stove Cover
- 12 volt Range Hood w/Fan, Light & Monitor Panel
- Double Door (LP/110V) Refrigerator
- Convection Micro Wave Oven
- Prep. For Surround Sound
- TV Antenna w/Booster
- 15,500 BTU Ducted Roof Air
- Battery and Case – Group 27
- Courtesy Lights at Hitch & Termination
- Telephone Jack
- 10 Gallon Water heater – G/E – DSI
- 40M BTU Furnace
- 75 Amp Power Center
- Battery Disconnect
- LP System w/30# Bottles

## Available Options

- Roof Rack & Ladder
- Exterior Shower
- Exterior Entertainment Center
- Scare Light
- Enclosed Underbelly
- Individual Electric Fifth Wheel Jacks
- Tor-Flex Axles
- 40# LP Bottles – IPO Std.
- 3 3/8"x12" Brakes – IPO Std.
- Thermo-Pane Sliding Windows
- Thermo-Pane Sliding Windows – Bronze
- Central Vacuum w/Attachments & Power Head
- Large Domestic 2 Door Refrig. #3862 – IPO Std.
- Ice Maker - #3862 Only
- Wilson Art Plank Flooring in Kit & Entry – IPO Std.
- Fan-Tastic Ceiling Vent with Thermostat
- Ceiling Paddle Fan
- Washer & Dryer – Some Models
- Prep for Generator – 50 Amp (Automatic)
- Maple Hard Wood Interior
- Air Ride Hitch

*Your Satisfaction Is Our Reputation!*



# “For The Long Run”

MARATHON 34 REAR BAY WINDOW LS FW W/50 REVERSE BATHROOM



MARATHON 35 TOY HAULER SINGLE SLIDE



MARATHON 39 5th Wheel 5 Slides/ 2 Rear Bed ISLAND KITCHEN



MARATHON 40-2 BEDROOM LS FIFTH WHEEL



MARATHON 42 RBW LS FIFTH WHEEL



MARATHON 44 5TH WHEEL 2 BEDROOM



MARATHON 44 - 2 BEDROOM LS FIFTH WHEEL W/REAR OFFICE

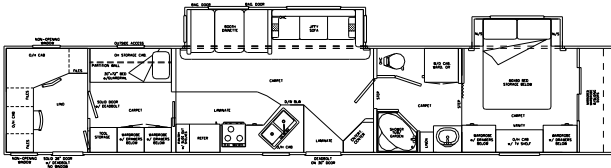

MARATHON 46 5th Wheel 5 Slides



MARATHON 46 5TH WHEEL SLEEPER UNIT 8



MARATHON 48 5th Wheel 2 BR 6 Slide



50' MARATHON FIFTH WHEEL ISLAND KITCHEN 2 BATH/ 5 SLIDES



50' MARATHON FIFTH WHEEL 2 BATH/ 6 SLIDES

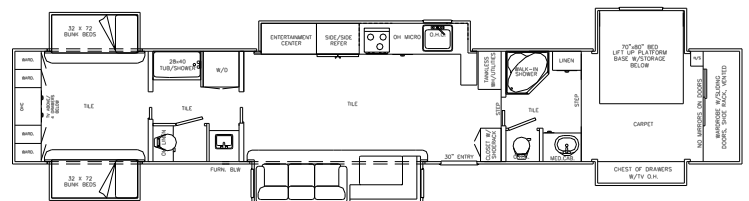

Marathon Homes, Corp.

Visit our website at:

[www.marathonhomes.com](http://www.marathonhomes.com)